



PRODUCT SHEET

Epoch Shelf
by Nina Bruun

Epoch Shelf

BY NINA BRUUN

Curved edges and warm materiality meet on the Epoch Shelf, designed by Nina Bruun. Crafted from oak veneer in two finishes, the wall-mounted design brings a natural touch to walls as a practical landing spot for hallway clutter or a space-enhancing base for decorative objects. It can be turned for use as either a deep tray or shallow shelf and multiples can be suspended in rows.



PRODUCT OPTIONS

SHELF 50



Natural Oak / Fog
6205039



Dark Stained Oak / Black
6205849

SHELF 79



Natural Oak / Fog
6207039

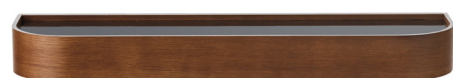

Dark Stained Oak / Black
6207849

Epoch Shelf

BY NINA BRUUN

TECHNICAL SPECIFICATIONS

PRODUCT TYPE

Shelf

COLLI

2

DIMENSIONS

50
H: 8 cm / 3,1"
W: 50 cm / 19,7"
D: 13 cm / 5,1"

79

H: 8 cm / 3,1"
W: 79 cm / 31,1"
D: 20,4 cm / 8"

PRODUCTION PROCESS

Bended plywood with oak veneer and high pressure laminate.

COLOURS

Natural oak / fog
Dark stained oak / black

MATERIALS

Plywood, oak venner and HPL

WEIGHT

50: N / A
79: N / A

PACKAGING TYPE

Gift box

PACKAGING MEASUREMENTS (H x W x D)

50
N / A

79
N / A

MATERIALS & MAINTENANCE

Please visit [menuspace.com](https://www.menuspace.com) for materials, care and maintenance instructions.

50

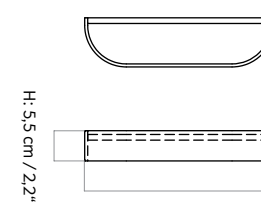

H: 5,5 cm / 2,2"

W: 50 cm / 19,7"

H: 1 cm / 0,4"

D: 13 cm / 5,1"

79

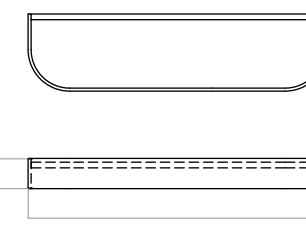

H: 5,5 cm / 2,2"

W: 79 cm / 31,1"

H: 1 cm / 0,4"

D: 20,4 cm / 8"